

TOOWONG TO WEST END AND ST LUCIA TO WEST END GREEN BRIDGES

Project update



Dedicated to a better Brisbane



November 2021



Message from the Lord Mayor

The Schrinner Council is building a green transport network across the city and can now reveal designs for two new green bridges to improve walking and cycling connections across the Brisbane River.

The Toowong to West End Green Bridge and the St Lucia to West End Green Bridge will connect more residents to parks, cafes, businesses and public transport, and make it even easier to walk and ride around our city.

The bridge concept designs have been developed following consultation and technical assessments, with more than 4,000 responses to alignment options earlier this year.

Following the announcement of the Brisbane 2032 Olympic and Paralympic Games, city-shaping projects like these green bridges will leave a lasting legacy for generations to come.

Together, they will add to our growing green transport network, supporting the vibrant communities

of West End, Toowong and St Lucia, as well as The University of Queensland.

Brisbane residents are passionate about Council continuing to deliver local infrastructure, and we will work with local residents and key stakeholders to get these city-shaping projects right.

I encourage you to have your say on the designs for these exciting projects and I look forward to keeping you up-to-date as planning progresses to deliver these vital new connections.

Adrian Schrinner
Lord Mayor



Faster and more convenient connections between work, study and lifestyle precincts



New and upgraded riverside parks



Improved access to high-frequency bus and rail services



River loop walking and riding experiences

Have your say

Council is seeking your feedback on the concept designs for the Toowong to West End and St Lucia to West End Green Bridges. **Have your say** by completing our online survey or by attending an upcoming information session (see back page for details).

New and upgraded riverside parks

The Toowong to West End and St Lucia to West End Green Bridges will provide new ways to enjoy our river's edge lifestyle.

At Toowong, a new landscaped riverfront green space and landing plaza will be created, with viewing platforms and seating providing space to rest and enjoy river views.

In St Lucia, the bridge landing at Guyatt Park has been designed to maximise park space and deliver new shade, seating and viewing areas.

At Orleigh Park, the bridge landings preserve existing heritage features and trees, where possible, to incorporate new and upgraded facilities, such as seating, lighting and signage.



Artist impression of proposed new riverside green space at Toowong bridge landing.

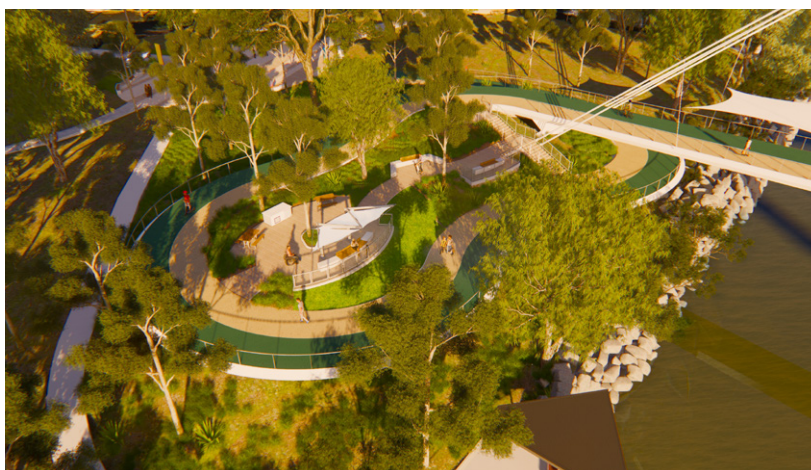

Artist impression of proposed bridge landing in Guyatt Park.



More **lifestyle** and **leisure** opportunities for local residents

Part of Council's long-term plan

Council is delivering more transport options and responding to our growing population, making it easier for residents and visitors to travel around our city now and into the future.

Building and investing in Brisbane's roads, bridges, footpaths, bike paths and e-mobility options is creating world-class public and active transport that will help residents navigate the city easily, and will leave a lasting legacy as we set our sights on the Brisbane 2032 Olympic and Paralympic Games.

Council's new green bridges are a vital part of this plan, making it even easier for our residents and visitors to get around our city on foot, by bike or scooter, or by connecting with public transport.

The new green bridges will link Kangaroo Point to the Brisbane CBD, Toowong to West End, St Lucia to West End, as well as a new crossing at Breakfast Creek. Council is also committed to investigating locations for a fifth green bridge and will make more information available as planning progresses.



About the Toowong to West End Green Bridge

The Toowong to West End Green Bridge will make it easier to walk or ride between the growing West End community and the Toowong Centre, rail and ferry services.

Council has prepared a concept design for the Toowong to West End Green Bridge based on the preferred alignment from the south east corner of 600 Coronation Drive, Toowong to Orleigh Park (near Forbes Street), West End.

The concept design aims to provide a modern bridge structure that touches lightly on the river's edge and provides new ways to enjoy the river and local parks.

Key features include:

- a curved single-mast cable stay bridge form with a length of about 280m and mast height of 75m above water level
- a single water-based pier on the Toowong side of the Brisbane River to minimise impacts on river users
- dedicated pathways for pedestrians and cyclists, with a minimum width of 6m and accessible grades
- a bridge clearance height of 11.4 metres, with provision for a 70m wide navigation channel
- a rest point and widened pathway (up to 9m) adjacent to the bridge mast with seating and viewing opportunities
- shade along the length of the pedestrian path
- a new riverside green space at the Toowong landing
- a landing at Orleigh Park that minimises impacts on open space and provides a direct connection to the walking and cycling network.

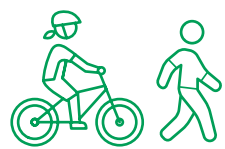

The Toowong to West End Green Bridge is expected to carry **3900 trips per day** by 2031 and **5300 trips per day** by 2041, based on assessments undertaken for the preliminary business case.



West End landing

The West End landing is located in Orleigh Park adjacent to Forbes Street, immediately north of the Brisbane and GPS Rowing Club, and the Cranbrook Place memorial site. This landing will provide:

- a direct connection to existing walking and cycling paths on Riverside Drive and Hill End Terrace
- ongoing connections to The University of Queensland via the proposed St Lucia to West End Green Bridge
- new subtropical planting and park upgrades.

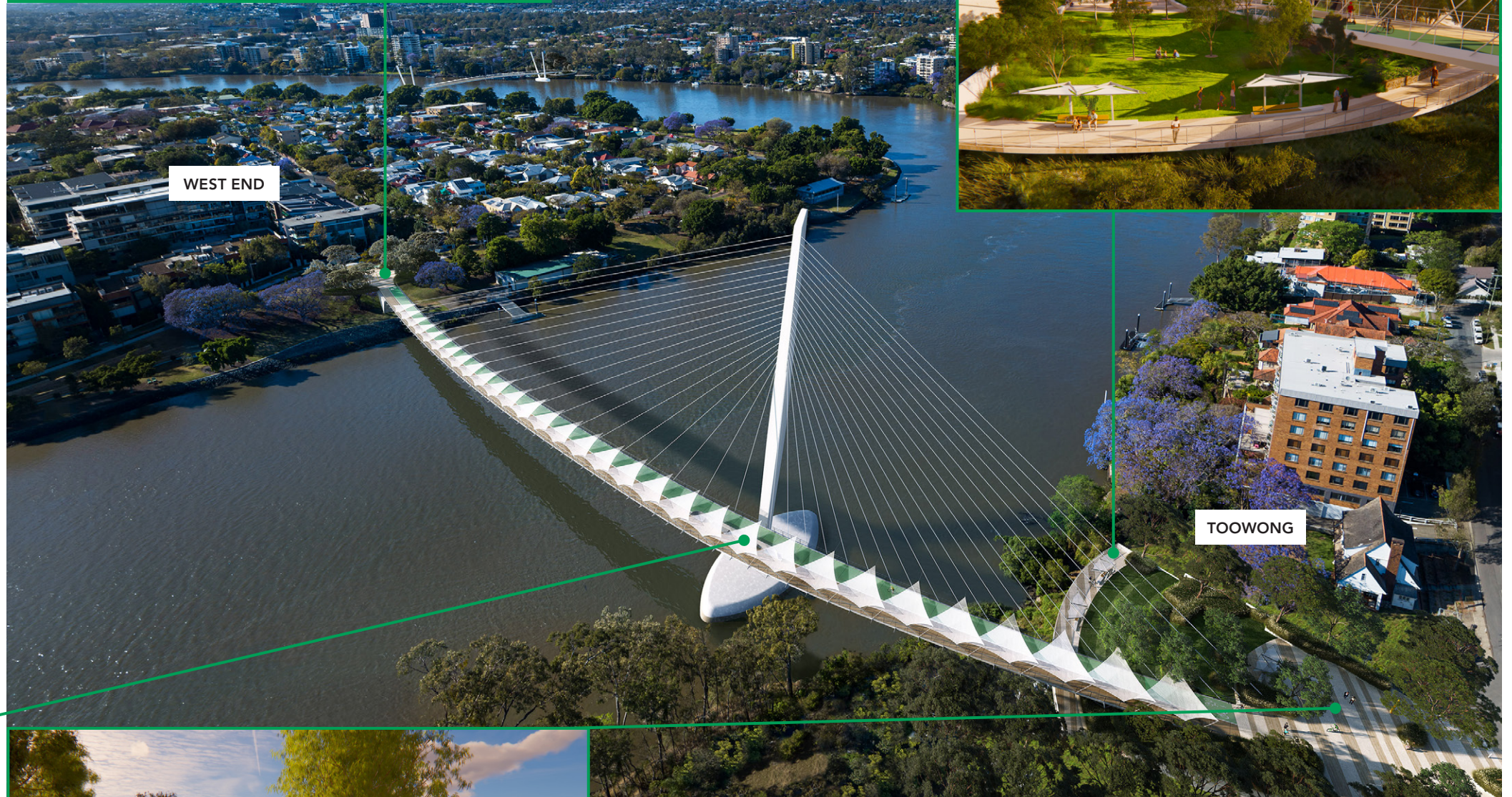

Toowong landing

The Toowong landing is located on the south east corner of 600 Coronation Drive, adjacent to Archer Street and south of Middenbury House. This landing will provide:

- a new riverside park and plaza with seating and landscaping
- connection to existing walking and cycling routes, via Archer Street
- opportunity for a future cycle connection through 600 Coronation Drive to the Bicentennial Bikeway.



About the St Lucia to West End Green Bridge

The St Lucia to West End Green Bridge will make it easier to walk or ride between St Lucia, The University of Queensland, West End, Highgate Hill and the CBD.

Council has prepared a concept design for the St Lucia to West End Green Bridge based on the preferred alignment from the riverfront of Guyatt Park, St Lucia to Orleigh Park (near Morry Street), West End.

The concept design aims to provide an elegant structure that responds to the suburban setting and seamlessly integrates into the surrounding park and residential setting on both sides of the river.

Key features include:

- a ground anchored long-span suspension bridge with four gently inclined masts, with a total length of about 310m
- dedicated pathways for pedestrians and cyclists, with a minimum width of 6m and accessible grades
- a bridge clearance height of 11.4 metres, with provision for a 70m wide navigation channel
- ensures CityCats can continue to operate safely at the West End and Guyatt Park ferry terminals
- rest points with seating and viewing opportunities at each end of the bridge
- shade across the full width of the main bridge span.

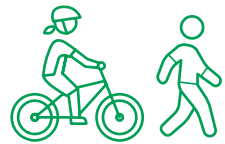

The St Lucia to West End Green Bridge is expected to carry **3500 trips per day** by 2031 and **4200 trips per day** by 2041, based on assessments undertaken for the preliminary business case.



West End landing

The West End landing is located in Orleigh Park near Morry Street, north of the West End ferry terminal and CityGlider bus stops. This landing will provide:

- access to and from the green bridge via an over-water circular ramp that minimises impacts on Orleigh Park
- access to high-frequency bus services
- new and upgraded seating, lighting and signage
- access to walking and cycling routes within Orleigh Park and Orleigh Street
- ongoing connections to Montague Road and Riverside Drive walking and cycling pathways.



St Lucia landing

The St Lucia landing is located on the central riverfront section of Guyatt Park, north of the Guyatt Park ferry terminal. This landing will provide:

- access to and from the green bridge via a ramp incorporated into the park
- improved riverside park space with opportunity for shade, seating and new elevated viewing areas
- walking and riding access through Guyatt Park to surrounding destinations including The University of Queensland.



Delivering city-wide benefits

The concept designs for the Toowong to West End and St Lucia to West End Green Bridges outline the potential bridge form and structure, design of the landing locations and features such as shade, viewing areas and landscaping.

Based on the concept designs, Council has prepared preliminary business cases for both bridges. These have been informed by a range of initial economic, transport and technical investigations that have assessed the costs, benefits and feasibility of the projects.

The preliminary business cases indicate these green bridges would provide a value for money investment for Brisbane ratepayers, delivering improved accessibility and green transport options which will result in reduced congestion, increased economic activity and health benefits. Key benefits of these green bridges include:

- ✔ Boosts inner city movement and cross river access
- ✔ Better connects existing active transport routes, including the Bicentennial Bikeway to The University of Queensland, and creates new strategic corridors in the inner city
- ✔ Reduces reliance on private vehicle trips and decreases vehicle emissions
- ✔ Supports growing e-mobility ridership
- ✔ Supports a clean, green and sustainable city and healthy lifestyle.

Find out more

Read more about the key findings of the preliminary business cases on Council's website.

Visit brisbane.qld.gov.au and search 'green bridges' or attend an upcoming information session in your area to learn more about the concept designs and benefits of the projects.



What you told us



Consultation on alignment options for the Toowong to West End and St Lucia to West End Green Bridges was undertaken from late 2020 to early 2021.

More than 4000 pieces of feedback were received, helping to inform the alignment for each bridge, and the development of the concept designs.

Key feedback raised during consultation included:

- support for new walking and cycling connections between Toowong, St Lucia and West End
- requests for new green space and to protect and enhance existing green space and vegetation
- strong support for the Toowong to West End Green Bridge to be delivered as a priority
- requests to minimise project impacts on river users and local residents.

Continued feedback will play a critical role in developing these green bridges, including ongoing connections to the city-wide walking and cycling network.

Council will continue to keep local residents and stakeholders informed about the projects as they progress.

What happens next?

Feedback on the concept designs will play a critical role in helping to finalise the bridge designs and business cases for the Toowong to West End and St Lucia to West End Green Bridges.

Previous consultation undertaken on both bridges clearly indicated many residents see the Toowong to West End Green Bridge as a greater priority for Brisbane.

In response to this feedback, Council would deliver the Toowong to West End Green Bridge first. Works could commence on the Toowong to West End Green Bridge as soon as 2024, subject to funding and approvals, with each bridge expected to take around two years to complete.



*Subject to funding and approvals

How to have **yoursay**

Your feedback on the concept designs will help inform the ongoing planning for the Toowong to West End and St Lucia to West End Green Bridges.

Complete our online survey or attend an information session to provide your feedback about the designs.

You might like to provide feedback on elements such as the design of the landing locations, landscaping and

urban design features, pedestrian and cyclist facilities or the overall bridge design.

Council is committed to working with the community to deliver these projects to help shape our city's future, making Brisbane an even better place to live, work and relax for generations to come.

Please have your say by 28 February 2022.

Date	Time	Location
Wednesday 17 November 2021	10am-1pm	The University of Queensland (Campbell Place), 280-284 Sir Fred Schonell Drive, St Lucia
Saturday 20 November 2021	9am-12 noon	Guyatt Park, Laurence Street, St Lucia
Wednesday 24 November 2021	11am-2pm	Queen Street Mall (Wintergarden entrance), Queen Street, Brisbane CBD
Saturday 27 November 2021	9am-12 noon	Orleigh Park (Area 3) at Montague Road, West End
Monday 29 November 2021	4-7pm	Toowong Library (meeting room), 9 Sherwood Road, Toowong
Tuesday 30 November 2021	4-7pm	St Lucia Bowls Club, 9 Carr Street, St Lucia
Saturday 4 December 2021	6am-2pm	West End Markets, Davies Park, Montague Road and Jane Street, West End
Wednesday 8 December 2021	4-7pm	South Brisbane Sailing Club, 68 Hill End Terrace, West End
Sunday 6 February 2022	9am-12 noon	Toowong Library (meeting room), 9 Sherwood Road, Toowong
Saturday 12 February 2022	6am-2pm	West End Markets, Davies Park, Montague Road and Jane Street, West End

Scan the QR code below for the latest updates. Sessions will be held in accordance with COVID Safe guidelines and session details are subject to change.

More information

You can also provide feedback by:

-  **contacting** the project team on 1800 318 166 (during business hours)
-  **emailing:** GreenBridges@brisbane.qld.gov.au
-  **writing to:**
Green Bridges Program
Brisbane City Council
GPO Box 1434
Brisbane QLD 4001



Scan here to complete the online survey or to sign up for project updates about the Toowong to West End and St Lucia to West End Green Bridges.